



HAND-HELD METAL DETECTOR

MAIN FEATURES

1. Digital design, strong anti-interference.
2. High sensitivity and easy operation.
3. Sound and LED alarm.
4. Three alarm modes: Vibration, Sound, Vibration+Sound.
5. Uses 2 AA batteries ,can operate for more than 100 hours.
6. Automatic sleep and power off. (2 min to sleep and 10min to power off)
7. When battery is low it will alert you with sound and lights.
8. Lights indicate charging.

COMPONENTS

- 1.Indicator light (Alarm, Charging, Low battery etc.)
- 2.Sound Hole
- 3.Button
- 4.Handle
- 5.USB interface
- 6.Battery cover
- 7.Detection area
- 8.Battery cover screw
- 9.Lanyard hole

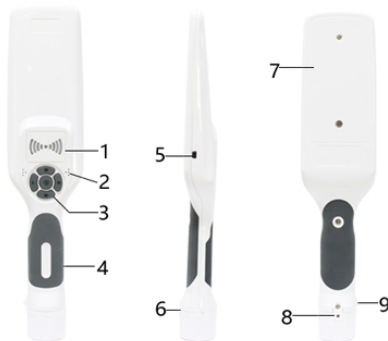

TECHNICAL DATA

Weight: 1.1 pounds

Size: 14.2 x 3.2 x 1.7 inches

Power supply: 2 AA rechargeable batteries (nickel-metal hydride)

Charger: Universal 5V USB charging (compatible with mobile phone charging)

Power: less than 60 milliwatts

Material: ABS plastic and rubber

Working temperature: -13°F to 140°F (Humidity: 0 to 95%)

INDICATOR DESCRIPTION

Alarm Indicator: with 3 levels.



Charging indicator: when charging light will flash as below image. When fully charged light will turn off.



When the battery is low, the indicator in the middle will flash rapidly and a quick alarm will sound.



OPERATION

Each button has an indicator light showing its operational status

Power on/off: press & hold the POWER SWITCH button for 2s to on/off.

(while it is on the power indicator will flash once by every 3s).

Sensitivity buttons: 4 levels (Low, Medium, High and Ultra-high).

For L, M, H, whichever level is selected, the indicator light will flash once by every 3s.

(Long press the H button for 10s to enter Ultra-high sensitivity mode. in this mode the H button light is off and only the POWER light flashes once intermittently)

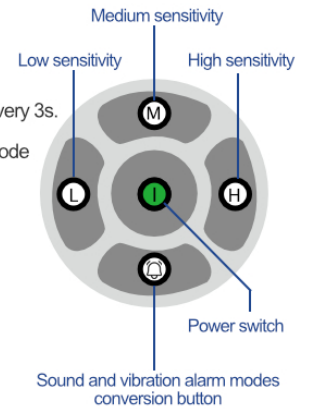

Sound and vibration alarm modes button:

Press the button once to change to one mode, press the button once again, to change to another mode.

DETECTION MODE

Three Detection Modes: Magnetic, Non-magnetic and Mixed metal detection mode.

